



OAKFIELD



Greenfield Road, Burwash, TN19 7BX

Price Guide £1,375,000



## Greenfield Road, Burwash, TN19 7BX

Price Guide £1,375,000 - £1,425,000

Set at the end of a private no-through lane and accessed via electric gates, this exceptional detached residence offers a striking blend of contemporary design, space and privacy. Occupying a beautifully landscaped plot of approximately 0.75 acres, the property enjoys a wonderful rural setting with far-reaching views across adjoining fields and countryside, while remaining within easy reach of Burwash village amenities.

Designed to maximise natural light, the home features impressive vaulted ceilings, extensive glazing and a seamless flow between the principal living spaces. At the heart of the property is a spectacular open-plan kitchen and dining area with a dramatic vaulted ceiling, triple-aspect outlook and full-height doors opening onto the gardens, creating an ideal environment for both everyday living and entertaining. High-quality finishes are evident throughout, including integrated Miele appliances, underfloor heating, CAT5 cabling, built-in speaker systems and solar panels.

The accommodation is arranged over three levels and offers generous proportions throughout, with four double bedrooms and a range of flexible reception spaces suited to modern family life. The lower ground floor provides excellent leisure and entertainment facilities, including a dedicated cinema room, gym/games room and wine store.

Outside, the landscaped grounds have been thoughtfully designed to create a private and tranquil setting, incorporating expansive lawns, mature planting, a pond with waterfall, productive vegetable gardens, woodland areas and a variety of seating and entertaining spaces. A substantial driveway provides parking for numerous vehicles and leads to twin garages with electric doors.

Combining contemporary luxury with a peaceful countryside backdrop, this unique home offers an outstanding lifestyle opportunity in one of East Sussex's most sought-after village locations, approximately half a mile from the heart of Burwash.





**Entrance Hall**

**Sitting Room**

24" x 16'10" (7.32m x 5.13m)

**Office**

10'6"x 9'11" (3.20mx 3.02m)

**Kitchen/Dining Room**

28'0" x 18'2" (8.53m x 5.54m)

**Utility Room**

**Conservatory**

24'2" x 17'9" (7.37 x 5.42)

**Shower Room**

**Bedroom One**

16'10" x 14'10" (5.13m x 4.52m)

**En-Suite**

**Bedroom Two**

12'5" x 10'10" (3.78m x 3.30m)

**Bedroom Three**

15'6" x 9'8" (4.72m x 2.95m)

**Bedroom Four**

11'0" x 10'2" (3.35m x 3.10m)

**Bathroom**

**Gym**

22'4" x 10'1" (6.81 x 3.08)

**Cinema**

15'0" x 13'0" (4.57m x 3.96m)

**Double Garage**

**Council Tax Band G-£4,501.58 per annum**

## Floor Plan

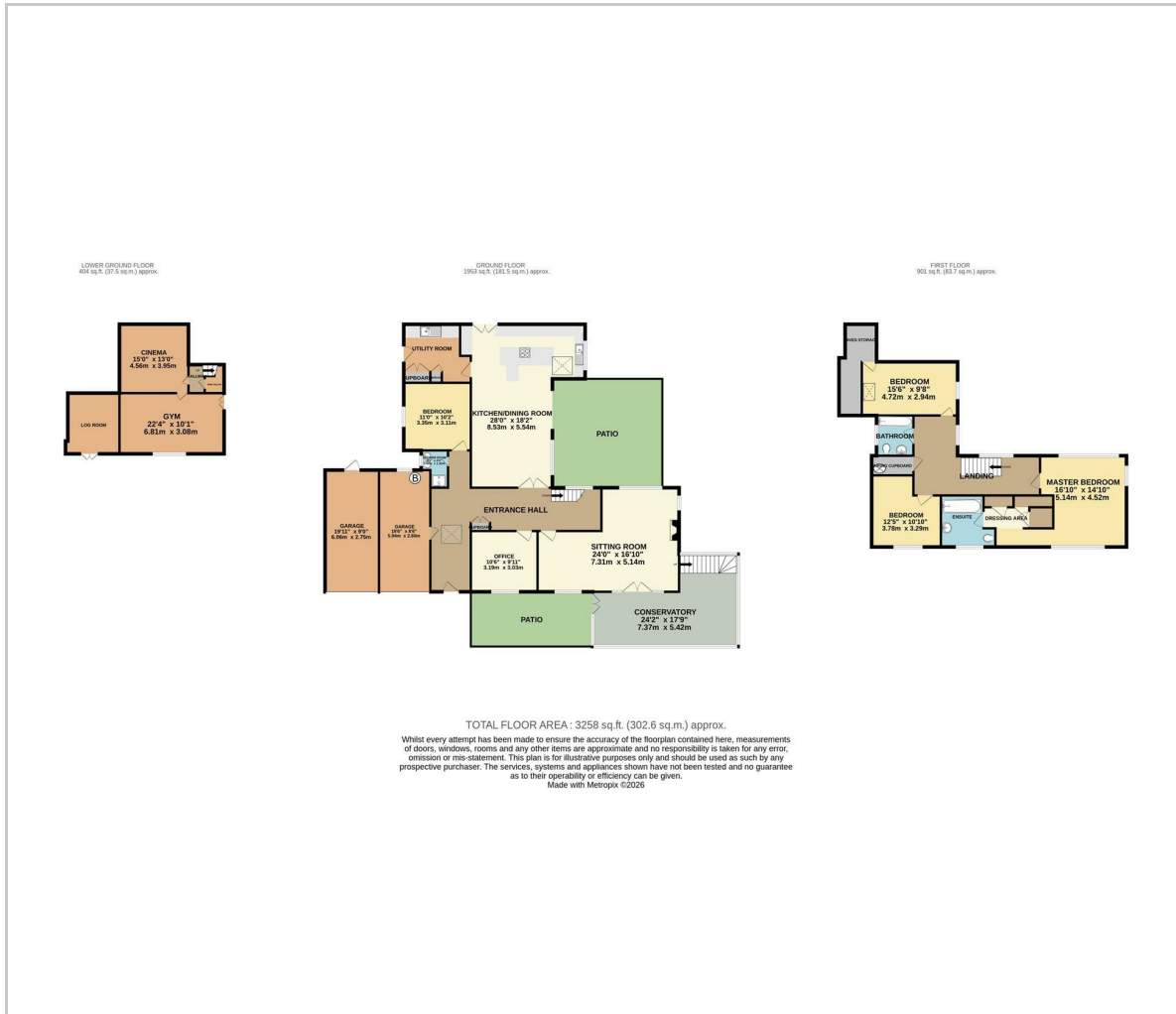

## Viewing

Please contact us on 01435 864233 if you wish to arrange a viewing appointment for this property or require further information.

These particulars, whilst believed to be accurate are set out as a general AREA outline for guidance and do not constitute any part of an offer or contract. Intending purchasers should not rely on them as statements of representation of fact, but must satisfy themselves by inspection or otherwise as to their accuracy. No person in this firm's employment has the authority to make or give any representation or warranty in respect of the property.

## Area Map

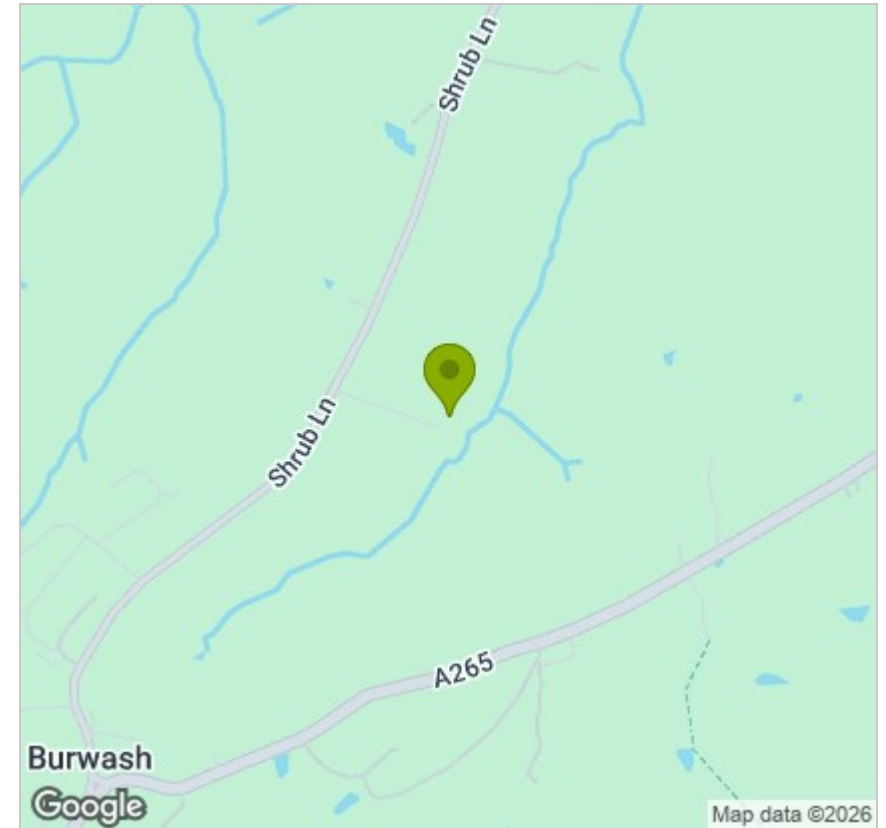

## Energy Efficiency Graph

